

CATALINA SUMMIT-8

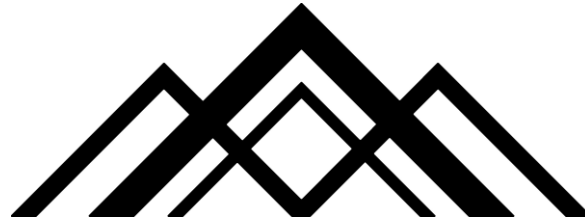

Training Manual

2025 Model Year Product

Table of Contents

All pages are hyperlinked below for direct link to that page

- [12V Power Stabilizer Jacks & Power Tongue Jack](#)
- [New Front Radius Lighting](#)
- [Heat Pump Info for GE AC Units](#)
- [GE Kitchen Appliances](#)
- [GE Refrigerator](#)
- [JBL Premium Sound System](#)
- [MORyde StepAbove Entry Steps](#)
- [Power Awning w/Multi-color LED Strip Lighting](#)
- [Optional 200-Watt Solar Panel](#)
- [Optional 30 Amp Solar Charge Controller](#)
- [Upgraded Dinette Features for 2025](#)
- [Upgraded Bedroom Features for 2025](#)
- [Stable Deck Tongue and Groove Flooring](#)
- [Screwed Cabinetry Construction & Benefits](#)
- [Seamless Counter Tops Construction & Benefits](#)
- [Black Tank Flush](#)
- [Rear Ladder Prep](#)
- [BAL NXG Frame](#)
- [NXG Through Frame Slide Out](#)
- [Optional Enclosed Underbelly](#)
- [Gas/Electric Water Heater & Furnace](#)
- [Additional Exterior Value Features](#)

FLOOR PLAN GUIDES:

- [211BH](#)
- [221EPIC](#)
- [221MKE](#)
- [231MKS](#)
- [261BH](#)
- [261BHS](#)
- [271DBS](#)

CATALINA

SUMMIT-8

BAL 12V Motorized Stabilizing Jacks & Power Tongue Jack

FREE feature for limited time!

Limited to fall program orders only. Talk to your sales managers for more information!



“See The Difference”

[Click Here or below.](#)



Key Features:

- ✓ Dual 12V motor for independent jack operation.
- ✓ Power jack LED lighting.
- ✓ 6" Wide, stable base, footpad.
- ✓ Two switches offer ease of side-to-side operation.
- ✓ Push button for quick, quiet extension & retraction.
- ✓ Superior E-Coat finish.
- ✓ Integrated foot to minimize slipping or sinking.

[Back To Table of Contents. Click Here](#)

CATALINA

SUMMIT-8

Exclusive Front Radius Lighting

FREE feature for limited time!

Limited to fall program orders only. Talk to your sales managers for more information!



“See The Difference”

[Click Here or below.](#)



- ✓ White LED radius lighting adds an upscale touch to the new graphics package for 2025 Catalina model.
- ✓ On/Off switch located in the pass-through storage.
- ✓ Show off your new Catalina and illuminate your campsite!

[Back To Table of Contents. Click Here](#)

*Powerful, reliable cooling performance
Engineered to deliver comfort, quality and long-lasting durability.*

INDUSTRY LEADING HEAT PUMP PERFORMANCE



HEAT PUMP + FURNACE

Extends Propane Usage Between 19-38% at 35° F Outdoor Temp*

In heat pump mode the RV's AC is working in reverse. Heat from the outside is utilized to supplement the furnace.

**Based on a propane furnace ranging from 20-40,000 BTU with 75% efficiency.*



AUTO CHANGEOVER HEAT PUMP

When the outdoor temperature drops below 25° F the heat mode automatically engages auxiliary heating sources, e.g., an RV furnace (if the RV is so equipped) to provide optimal comfort.



HEAT PUMP OPERATION AS LOW AS 25° F

This feature ensures that any ice buildup on the heat exchanger is cleared by periodically cycling to Auto Defrost. With the reverse cycle defrost algorithm, the heat pump can continue to provide supplement heating with outdoor temperatures as low as 25° F.



MULTIPLE HEATING MODES

3 heating modes available: heat pump only, heat pump + furnace, and furnace only. Flexible heating mode gives RVs more options to configure the ideal comfort setting and provide the ability to set a preferred automatic setting.



HIGH-EFFICIENCY RVAC

Using large heat exchangers along with high efficient compressors, allow RV owners to install up to 3 AC units on one 50-amp equipped RV. In addition, owners can install more electronic equipment without overloading the electrical circuits.



Models include cool only, heat pump & high-efficiency cool only

How it works:

The AC process is reversed. Heat is pushed through the ducting and cold air is vented outside.

Key Features:

- ✓ Electric heating source that extends propane usage between 19-38% at 35°F.
- ✓ Operates as low as 25°F outside temp.
- ✓ All heat modes are controlled through the wall mounted thermostat for each AC unit.
 - Heat pump only
 - Heat pump + Furnace
 - Furnace only

CATALINA SUMMIT-8



GE APPLIANCES
a Haier company

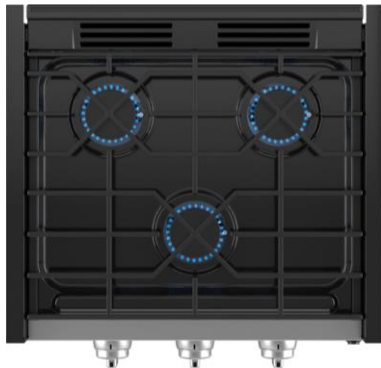

GE® 17" RV Gas Range, Vented Range Hood, and Microwave

Range & Oven Features Include:

- ✓ **Edge-to-Edge Grates** – Easily move cookware on this seamless surface cooktop with continuous black matte grates.
- ✓ **Easy-Clean Enamel Oven** – The smooth enamel surface makes it difficult for grease and other dirt to stick to it.
- ✓ **Spark Ignition System** – Easily light each burner by turning on the burner a creating a spark with the spark ignition knob
- ✓ **Cast Metal, White Backlit, Range Knobs** – Heavy cast metal knobs offer durability with a high-end look. White backlit range knobs can be conveniently turned on and off.
- ✓ **Nickle Oven Rack w/Multiple Positions** – 2 flexible oven rack positions to accommodate a variety of cookware.

Range Hood & Microwave Features Include:

- ✓ **Watts & Power Levels** – This is a 900W microwave is on the high end of the wattage spectrum for its size. It also comes with 10 power levels!
- ✓ **Convenience Cooking Controls** – 7 convenient easy cook modes like popcorn and reheat buttons.
- ✓ **Instant On Controls** – Instantly set the timer between 1-6 minutes with the press of the instant on control button.
- ✓ **Filtered and Ducted Range Hood** – Fumes and odors are vented outside of your RV. The aluminum mesh filter can be easily washed under water!

[*Back To Table of Contents. Click Here*](#)

CATALINA SUMMIT-8



GE APPLIANCES
a Haier company



GE® 9.8 Cu. Ft. 12 Volt DC Power Top-Freezer Refrigerator

Features Include:

- ✓ **Semi-Automatic Defrost** – designed to save energy and improve battery performance.
- ✓ **Deep Freezer w/ a Shelf** – Accommodates larger items; even a bag of ice.
- ✓ **Adjustable Glass Fridge Shelves** – Two adjustable shelves to organize food storages.
- ✓ **Door Bins/Storage** – Frees up shelf space in the fridge & freezer.
- ✓ **Clear Crisper Drawer** – Helps preserve fresh fruits and vegetables.
- ✓ **LED Lighting** – Energy efficient and bright.
- ✓ **Compressor Cooling System** – No external ventilation required.
- ✓ **12V DC Power** – Specifically engineered for the RV and boat industries.

Differentiation Benefit: Wall Switch for the Refrigerator

- ✓ Catalina wires our 12V refrigerators to a switch located next to the refrigerator giving the owner the ability to turn off the refrigerator completely

****The 12V refer is a standard build item. Catalina offers a 7 cu. Ft. gas/electric RV refer as an option.**

[*Back To Table of Contents. Click Here*](#)

CATALINA

SUMMIT-8

JBL Premium Sound System



The Benefits:

- ✓ 2 Zones of Audio Control with dual zone control.
 - Have the TV/Radio playing through interior speakers (zone A) with a Bluetooth device playing on the outside speakers (zone B).
- ✓ Bluetooth Connectivity.
- ✓ FM Tuner with 10 Presets.
- ✓ HDMI ARC Cable Installed to Connect to TV (Yellow HDMI Plug).
- ✓ Parametric Lighting with 3 Different Light Modes.
- ✓ Interior JBL Speakers Specifically Paired for Optimal Sound.
- ✓ Exterior Speakers Specifically Paired for Optimal Sound.

Differentiation Benefit: Name Brand Sound System

- ✓ Catalina uses the JBP Premium Sound System. Very few other brands in our segment even know what sound equipment they are using!



[Back To Table of Contents. Click Here](#)

CATALINA

SUMMIT-8

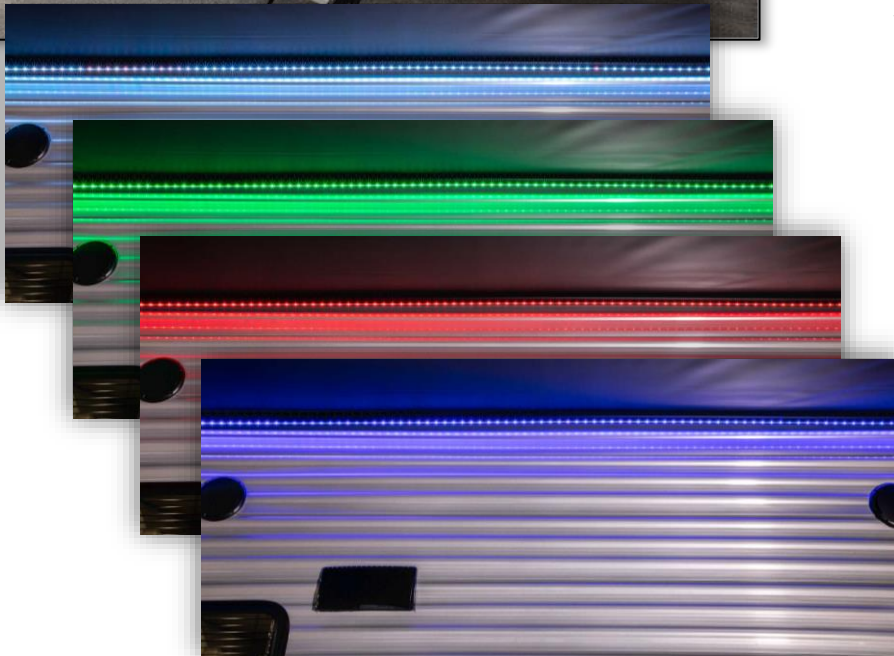

Multi-Colored LED Lighted Power Awning

Key Features:

- ✓ **No Hassle Power Awning** – *push button on the OneControl board, or open with your OneControl app!*
- ✓ **Heavy Duty Vinyl Fabric** – *Anti-mildew, Anti-scuff, and cold-crack tested.*
- ✓ **Adjustable Pitch** – *Pitch control on each arm allows for better sun blocking coverage. It also helps avoid pooling water!*
- ✓ **8' Extension** – *Solera Awnings extend out 8 ft. for plenty of camp site shade coverage.*
- ✓ **Multi-Color LED Light Strip w/Remote**
 - *Provides 15 different colors + white. Also includes features such as strobe, flash, fade, or smooth transition between*

Select OEMs may offer RGB (color) LEDs.

These lights use a separate IR (Infrared) remote and sensor. The top of the remote must be pointed at the infrared sensor on the LED receiver module.

The remote control provides:

- Simple push button on/off
- Adjustable dimming
- 15 color choices + white
- Special effects (flash, strobe, fade and smooth)

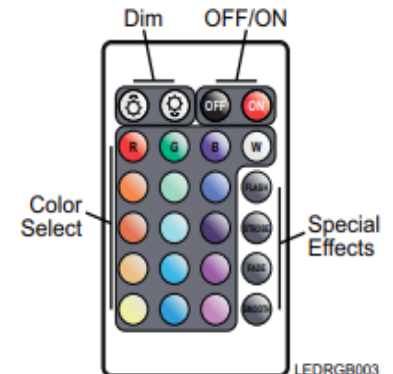

[Back To Table of Contents. Click Here](#)

CATALINA

SUMMIT-8

MORryde StepAbove

Entry Steps

Key Features:

- ✓ Bounce-free, wobble-free stability
- ✓ Lightweight; Easy to stow and unstow
- ✓ Quick release leg adjustment; NO PINS!
- ✓ Wide top step for safety
- ✓ Gradual step slope for full foot placement
- ✓ 500lb. Weight Capacity



Entry Steps Vendor Video

Click to play video



[Back To Table of Contents. Click Here](#)

CATALINA SUMMIT-8

Go Power! 200 Watt Solar Panel

All Catalina's are wired and prepped for solar capabilities. The panel and charge controller is an optional add from the factory.

RELIABLE POWER, ANYWHERE



SPECIFICATIONS

Rated power (Pm)	200W
Maximum power voltage (Vmp)	20.8V
Maximum power current (Imp)	9.62A
Open circuit voltage (Voc)	24.3V
Short circuit current (Isc)	10.09A
Power coefficient	-0.39% / °C
Voltage coefficient	-0.31% / °C
Current coefficient	0.045% / °C
Max power tolerance	+/- 5W
Cell type	Monocrystalline
Module efficiency	21.5%
Series fuse rating	15A
Maximum system voltage	600VDC (UL / IEC)
Weight	26.4 lb (12 kg)
Dimensions	59.06 x 26.3 x 1.57 in 1500 x 668 x 40 mm
Materials	Clear anodized aluminum frame; tempered glass
Warranty (Power Output)	25 years

Power Specifications calculated at STC:
• Irradiance: 1000 W/m²
• Cell Temperature: 77 °F (25 °C)
• Air Mass: 1.5

Key Benefits:

- ✓ **Produces 9.6 amps** of power charging capability, **per hour**, under standard solar conditions.
- ✓ Capable of running a 12V refrigerator.
- ✓ Monocrystalline power cells for higher efficiency.
- ✓ Industry standard quick connect cables.
- ✓ 25-year limited solar panel output power warranty.

[Back To Table of Contents. Click Here](#)

CATALINA

SUMMIT-8

Go Power! 30 Amp Bluetooth

Solar Charge Controller



Key Benefits:

- ✓ Capable of handling up to **600 watts of solar power.**
- ✓ **Bluetooth® ready** with the Go Power! Connect app.
 - Set the battery type and charging profile
 - Turn your compatible Go Power! ISW Inverter on or off
 - Toggle Maximum Power Boost mode
 - View essential battery stats, including:
 - Battery Voltage
 - PV Charging Current
 - Battery State of Charge (SOC)
- ✓ **Regulates current flow** from your solar modules to your batteries.
- ✓ Temperature compensated pulse width modulation (PWM) charging.
- ✓ 4 battery charging profiles: Sealed/Gel, AGM, Flooded and LiFePO4 (lithium).
- ✓ 4 stage charging: Bulk, Absorption, Float and Equalize.
- ✓ Back lit LCD screen displays charging current, battery voltage and battery state of charge.
- ✓ Built-in USB charge port.
- ✓ Heavy-duty terminals for low resistance connections.
- ✓ Suitable for 12V solar systems up to 30 amps.
- ✓ 5-year warranty.

Solar Sizing
Worksheet
Click PDF →



[Back To Table of Contents. Click Here](#)

GP-SB-PWM-30BT SPECIFICATIONS

Nominal System Voltage	12V
Nominal Charge Current	30A
Battery Voltage Range	6V -- 16Vdc
Max Battery Charge Current	37.5A
Max Solar Power	600W
Display Consumption	15mA
Temp. Compensation	- 25mV/°C
Operating Temperature	- 40 to 60°C / - 40 to 140°F
Humidity	99% N.C.
Dimensions (H x W x D):	5.87 x 3.86 x 1.26 in; 149 x 98 x 32 mm
Weight	260 g / 9.2 oz
Maximum Wire Gauge:	#8 AWG/10 mm²
Warranty	5 years
Protection	Battery/Solar Reverse Polarity, Battery/Solar Short Circuit, Battery/Solar Reverse Current, Battery/Solar Over voltage up to 50V, Over temperature, Over Current

Upgraded Dinette Features

Key Features:

- ✓ **Camco blocks** added in place of the wood stiles for table support when in bed mode.
- ✓ U-shape dinette **back bench storage opened** for easy access. Includes storage totes!
- ✓ **Velcro strip dinette cushions** to keep cushions in place every time.
- ✓ Thermofoil dinette tabletop is seamless. Making in longer lasting and moisture proof, unlike t-mold or self edge tabletops that contract over time leaving gaps.
- ✓ Easy access storage doors under the bench seats!



CATALINA

SUMMIT-8



Upgraded Bedroom

Features

Key Features:

- ✓ **NEW Rear wardrobe shelf/cubby** adds convenient, easy access, storage at the head of the bed.
- ✓ **Full length nightstands** opens the area next to the bed and provides more space.
- ✓ **12V USB/USB C and 110 Outlets** on both sides of the bed to meet the modern worlds power needs.
- ✓ Our under-bed storage is finished off separating the exterior pass-through storage from the interior bed storage.

[Back To Table of Contents. Click Here](#)

ADVANTAGES

Travel and outdoor enthusiasts need RVs that can withstand the elements. Our deck panels are precision-engineered specifically for RVs to provide a stronger core, moisture resistance, and more stability for the long haul.

Our sanded 2 sides engineered panels afford the thickness tolerance requirement of components in the most precise applications. Our panels are manufactured with additional resins and wood to deliver extra strength and rigidity where needed. Our product line is manufactured in multiple locations across North America to help reduce customers' transport costs.

All products are CARB (California Air Resource Board) - exempt and free of any urea-formaldehyde resins.



BENEFITS

ESP PLYWOOD OSB

	ESP	PLYWOOD	OSB
Used in Cargo and RV trailers for years	✓	✓	✓
100% MDI Resin for water resistance	✓	✗	✗
Superior anti-swell properties	✓	✗	✗
Sanded two sides so panel remains flat	✓	✗	✗
Formulated for enhanced strength & density	✓	✗	✗
Superior screw-holding	✓	✗	✗
Uniform thickness	✓	✗	✗
One Year Limited Warranty	✓	✗	✗

THICKNESS

5/8" Sanded 2-Sided

LENGTHS

4'x8' 4'x102"

WARRANTY

Limited Warranty

TESTING DATA & COMPARISON

	Density (pcf)	Internal Bond (psi)	Parallel Bending Stiffness (EI parallel)	Perpendicular Bending Stiffness (EI Perpendicular)	Parallel Bending Strength (MM para)	Perpendicular Bending Strength (MM perp)	Thickness Swell (%)	Water Absorption (%)	#10 Screw Pull Through	#12 Screw Pull Through	#14 Screw Pull Through
ESP Engineered Structural Panel	40	118	374,978	195,819	6,166	4,425	4.9	13.9	665	852	1011
Standard OSB	38	263,961	88,326	1,735	1,735	36.1	49.3				
OSP Plywood Testing (Published Data)	36	127	330,000	57,000	2450	850	8.8	45	415	470	525

Manufacturer Test results above represent a random sampling of product produced for Trailer applications - test results will vary from run to run and should not be considered minimum standards. OSB/Plywood numbers are from the APA and other published reports used for engineering values.



Key Features:

- ✓ 100% MDI Resin for water resistance and anti-swelling properties.
- ✓ Sanded 2 sides, free of patches, putty, and other imperfections such as knotholes or core voids.
- ✓ Engineered to lie flat: resistant to twisting, cupping, cracking, warping, and delamination.
- ✓ Engineered with extra strength and rigidity.
- ✓ Superior fastener holding; staples and screws will not work out over time.

The Catalina Cabinet Process



Lumber Core Stiles:

Our construction requires us to use real lumber core stiles, so the screws have something to grip into securely.



Pocket Holes:

Using a jig, we drill precise pocket holes for the screws we use in our construction. This ensures quality and strength every time.



Framing Table:

No guess work! This ensure the right angles and strongest fit for all of our cabinets.

[Check Out Our Video!](#)
[Click Here](#)



X Particle Board

- Not a strong material core material for construction
- Does not stand up to temperature changes and humidity

X Stapled

- Does not offer the same security and hold as screws
- Inconsistent from stile to stile and cabinet to cabinet

X Construction

- Stapled cabinets are often built without the use of a framing table. This creates inconsistencies, gapping and unlevelled cabinets.



[Back To Table of Contents. Click Here](#)

CATALINA

SUMMIT-8



Correct material is selected and loaded, then parts are cut by our CNC routers, automatically switching between tools for desired finished appearance.



After parts are cleaned of debris, they are moved to the glue department. Surfaces that require vinyl are sprayed evenly and thoroughly.



The parts are now sent into the press, where heat and pressure will form and adhere the vinyl to the substrate.



Parts are now hand trimmed to remove excess vinyl, placed with the order, and sent to packaging.

Seamless Thermofoil

Counter Tops

The production process and key quality indicators:

- ✓ CNC routed to specific engineered specs
- ✓ Complete glue coverage preventing separation or gaps
- ✓ Totally seamless coverage of the substrate; no gaps & separation
- ✓ Heat and pressure adherence process for a smooth high-quality finish
- ✓ Hand trimmed to prevent damage and ensure quality coverage

At Catalina we use our thermofoil counter tops in:

- ✓ The Kitchen/Galley
- ✓ Dinettes
- ✓ Camp Kitchens
- ✓ Bathrooms

AVOID THIS!



[Check Out How They're Made!](#)
[Click Here](#)

[Check Out Our Video!](#)
[Click Here](#)



If necessary, the products are sent to buildup. Here buildup (drop edge) is applied. CNC routed buildup is glued then pin-nailed in place.



[Back To Table of Contents. Click Here](#)



ADVANTAGES:

- ✓ **Quicker** black tank cleaning process.
- ✓ **Easier** method with no additional equipment needed.
- ✓ **Cleaner** than dumping water buckets or pulling a hose through your camper.

3 easy steps!

1. Connect the hose to your black tank flush port
2. Open your black tank evacuation valve
3. Turn on the water.

[Check Out Our Video! Click Here](#)



*Traditional black tank cleaning methods require **more equipment, take longer and are messy***



You're going to need a long hose!



You have to drag it through your camper to the bathroom.



Fight the hose and cleaning attachment down the toilet.



Hoping the tank is getting cleaned properly as you twist and turn the hose.



What a mess! Now what?



Getting the dirty hose back out of your trailer. Yikes!

[Back To Table of Contents. Click Here](#)

CATALINA

SUMMIT-8

Rear Ladder Prep



Key Features:

- ✓ Portable, telescoping ladder for RVs
- ✓ 12' 6" or 14' 6" telescopic extension
- ✓ Weighs less than 30 lbs.
- ✓ Retracts to 33.5" or 35.75" for easy storage and transport
- ✓ Sturdy 330 lb. weight capacity
- ✓ Angled extension reaches 22" above your RV for added stability
- ✓ User-friendly, fast extension and retraction
- ✓ Segmented locks on each step for increased retraction control
- ✓ Only compatible with RVs equipped with the Lippert ladder receiver

[Back To Table of Contents. Click Here](#)



Fully Integrated into our
NXG Hucked Frame

Key Benefits:

- ✓ Manufactured with HSLA – **High Strength Low Alloy Prime Steel** with specifically controlled properties.
- ✓ **CNC controlled rail fabrication eliminated inconsistency** of frame components, including spring axle hanger placement.
- ✓ Mechanically and CNC applied to achieve the desired **positive camber, specific to each floorplan**
- ✓ Component parts are **painted separately, then assembled.**
- ✓ **Manual welding is minimized.** Common components are **robotically welded for consistent quality.**
- ✓ All fastened components are joined with Huck® fasteners. **Huck® fasteners provide consistent clamp load**

Eliminates:

- ✓ Frame failures due to sub-standard steel.
- ✓ Inconsistent placement of frame component parts.
- ✓ Uneven main rails – varying camber and squareness.
- ✓ Corrosion caused by incomplete paint coverage.

CATALINA

SUMMIT-8

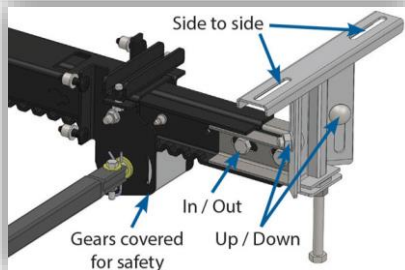
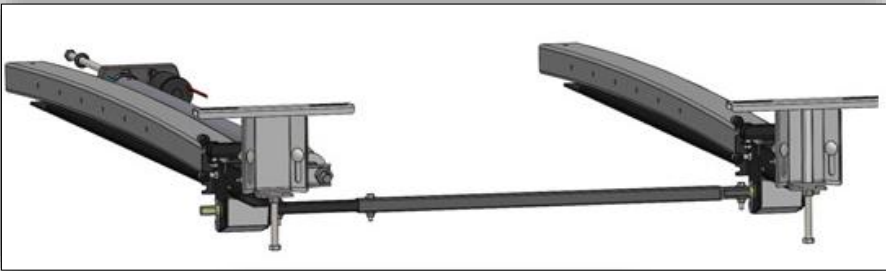

Through Frame Slide Out

NXG FRAME

Description

BAL has set the new standard in slide-out technology with the award winning 'NXG SLIDE' rack drive slide-out. The NXG SLIDE system provides an unmatched level of durability and precision that was not available in older generations of slide-out mechanisms. Due to the systems rigidity and tightness, a user should experience years of trouble-free performance. All components of the NXG SLIDE mechanism are individually coated with highly effective corrosion-resistant e-coat or plating for extended life of the slide-out drive. Required maintenance is limited to periodic cleaning and lubrication of the main drive arms of the system. U.S. patent pending.

Key Features:

- ✓ **Arched Design** – Strong, tighter, and more durable design that helps hold the room against the trailers side wall.
- ✓ **Rack and Pinion Drive System** – Simple and reliable system with a single motor and easy manual override.
- ✓ **More Space!** – Rack and pinion slide systems offer more head room and more depth than other slide systems on the market today.
- ✓ **Slide Room Supported by Frame** – The through frame design means the slide room itself is engineered into the frame for that specific floor plan. This adds support to the slide room and helps take the load off the sidewalls.

[Back To Table of Contents. Click Here](#)

CATALINA

SUMMIT-8

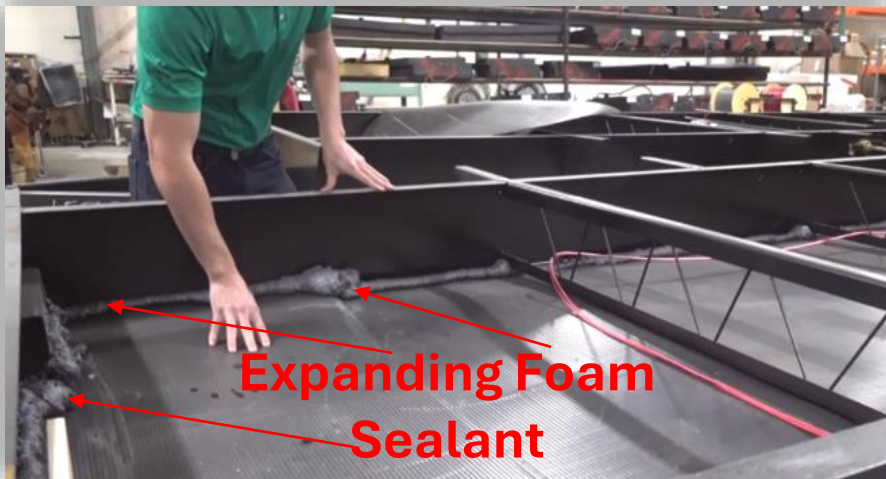

OPTIONAL Enclosed & Sealed Underbelly

Only Available on 221MKE, 231MKS, 261BHS, 271DBS, 281QBUNK

Key Features:

- ✓ Protects holding tanks, plumbing, and electrical components from the elements and debris when traveling.
- ✓ We use expanding foam sealant to completely seal the underbelly. This creates a “dead air” space for added insulation properties.
- ✓ Traps radiating air from our in-floor heat ducts.
- ✓ Improves tow ability by reducing drag and buffering.

[Check Out Our Video! Click Here](#)



[Back To Table of Contents. Click Here](#)

CATALINA

SUMMIT-8

35,000 BTU Furnace



Dare to Compare!

Very few direct competitors use a
35,000 BTU furnace!

ADVANTAGES:

- ✓ Longer Camping Season
- ✓ More Comfort in Lower Temperatures
- ✓ Less Run Time to Maintain Temperature;
Saves Propane

283RKS floor plan equipped with 30,000 BTU IPO 35,000 due to build code
limitations

Water Heater & Furnace

6 Gal. Gas & Electric Water Heater

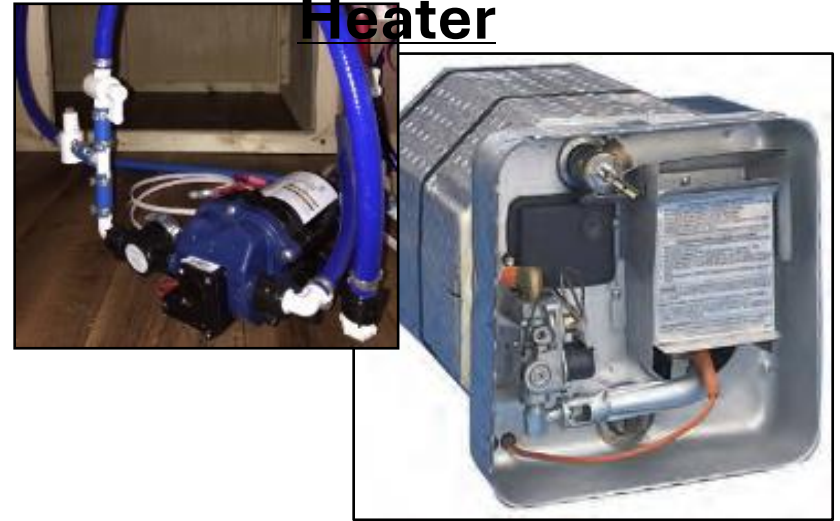

ADVANTAGES:

- ✓ **Direct Spark Ignition** allows the user to start the water heater from inside their camper.
- ✓ **Quick Recovery** allows up to 16.2 gallons of water to be heated per hour
- ✓ **Gas and Electric** feature is STANDARD compared to gas only models used by the competition
- ✓ **Water Pump/Winterization Kit** (shown in the picture above) allows the user to easily bypass and winterize their own camper.

[*Back To Table of Contents. Click Here*](#)

CATALINA

SUMMIT-8

Exterior Added

Convenience Features

G20 Tinted Windows



THE BENEFITS:

- ✓ Only 20% of UV light gets through.
- ✓ Keeps the unit cooler.
- ✓ Protects furniture from sun fade.
- ✓ Adds some privacy during the day.

360 Siphon Roof Vent Cap

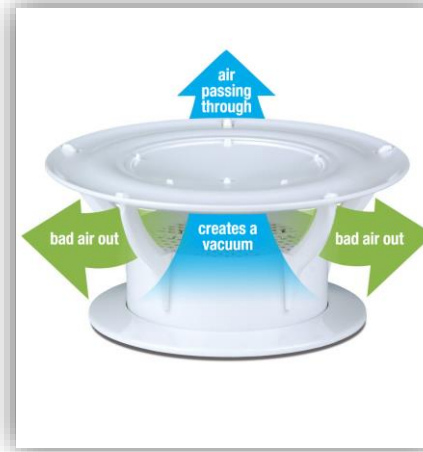

THE BENEFITS:

- ✓ Air passing through creates a vacuum.
- ✓ Gases are drawn out.
- ✓ Eliminates Odor.
- ✓ Built-In Screen Keeps Bugs Out.

Battery Disconnect Switch



THE BENEFITS:

- ✓ Completely Disconnects the Battery from All Systems.
- ✓ Saves Battery Life.
- ✓ Conveniently Accessible on the A-Frame.

[Back To Table of Contents. Click Here](#)



211BH

Floorplan Guide



Dry Weight	Hitch Weight	GVWR	Length	Width	Height	Fresh Tank	Grey Tank	Black Tank
4,585 lbs.	544 lbs.	7,544 lbs.	25' 11"	96"	11' 1"	44 gal.	40 gal.	30 gal.



Key Floorplan Features:

- ✓ Under 26' Real Length; Light Weight and Tow Friendly.
- ✓ Direct View Entertainment.
- ✓ Standard Reclining Theater Seating.
- ✓ Modified Dinette; Half bench Seating with Storage Below, Half Free-Standing Chairs.
- ✓ Extra Large Dinette Window AND Rear Window.
- ✓ Deep, Shelved Pantry Storage.
- ✓ Shallow Slide Out Provides More Living Space without Adding Significant Weight.
- ✓ Complete Pass-Through Storage at the Front with Additional Storage Compartment on Camping Side.
- ✓ 15 ft. Power Awning Providing Camp Side Coverage and Multi Color LED Lighting.
- ✓ All-In-One Monitor Control Panel.

[Back To Table of Contents. Click Here](#)

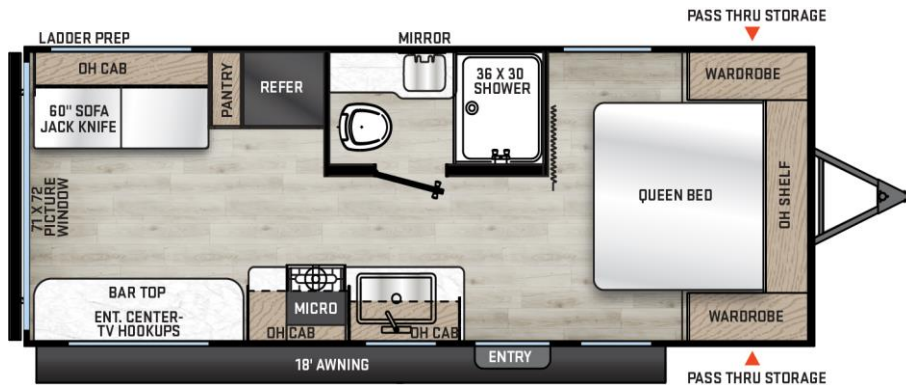

Dry Weight	Hitch Weight	GVWR	Length	Width	Height	Fresh Tank	Grey Tank	Black Tank
4,627 lbs.	558 lbs.	6,127 lbs.	25' 11"	96"	11' 1"	44 gal.	44 gal.	30 gal.

Key Floorplan Features:

- ✓ Under 26' Real Length; Light Weight and Tow Friendly.
- ✓ Floor to Ceiling Penthouse Style Rear Viewing Window.
- ✓ Bar Style Countertop with Barstools and Picture Window.
- ✓ 60" Jack-knife Sofa with Overhead Storage.
- ✓ Front Master Bedroom with Queen Bed and Opposing Side Nightstands and USB's.
- ✓ Extended Kitchen Countertop with Large Kitchen Sink.
- ✓ G/E Appliance Package Includes 3 Burner Stove top, Microwave and Refer.
- ✓ Complete Pass-Through Storage at the Front of Trailer.
- ✓ 18 ft. Power Awning Providing Camp Side Coverage and Multi Color LED Lighting.
- ✓ All-In-One Monitor Control Panel.

[Back To Table of Contents. Click Here](#)

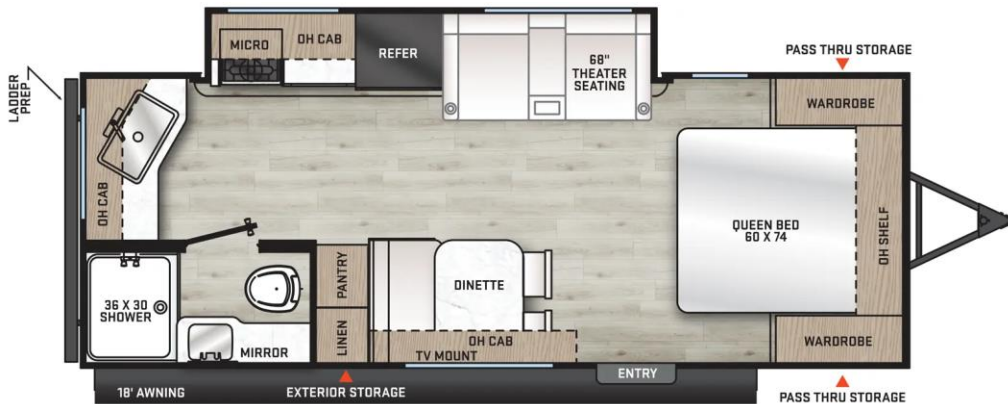

Dry Weight	Hitch Weight	GVWR	Length	Width	Height	Fresh Tank	Grey Tank	Black Tank
5,341 lbs.	606 lbs.	7,606 lbs.	25' 11"	96"	11' 1"	44 gal.	40 gal.	30 gal.

Key Floorplan Features:

- ✓ Under 26' Real Length; Light Weight and Tow Friendly.
- ✓ Direct View Entertainment.
- ✓ Standard Reclining Theater Seating.
- ✓ Modified Dinette; Half bench Seating with Storage Below, Half Free-Standing Chairs.
- ✓ Extra Large Dinette Window and Rear Window.
- ✓ Deep, Shelved Pantry Storage.
- ✓ Shallow Slide Out Provides More Living Space without Adding Significant Weight.
- ✓ Complete Pass-Through Storage at the Front with Additional Storage Compartment on Camping Side.
- ✓ 18 ft. Power Awning Providing Camp Side Coverage and Multi Color LED Lighting.
- ✓ All-In-One Monitor Control Panel.

[Back To Table of Contents. Click Here](#)



231MKS

Floorplan Guide

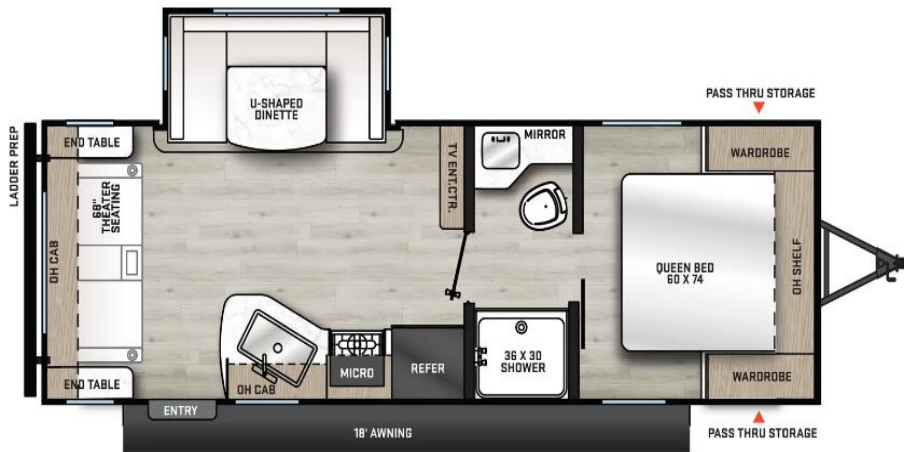

Dry Weight	Hitch Weight	GVWR	Length	Width	Height	Fresh Tank	Grey Tank	Black Tank
5,101 lbs.	658 lbs.	6,700 lbs.	28' 2"	96"	11' 1"	44 gal.	40 gal.	30 gal.

Key Floorplan Features:

- ✓ Under 29' Real Length.
- ✓ 5,100 lb. Dry Weight; Half Ton Towable.
- ✓ Many Living Room and Kitchen Windows for Natural Sunlight.
- ✓ Private Master Bedroom with Sliding Door and Opposing Windows.
- ✓ Extra Large Rear Sofa; Direct View Entertainment.
- ✓ Rack and Pinion Super Slide with U-Shaped Dinette.
- ✓ Spacious Bathroom with Walk-in Shower and Additional Countertop.
- ✓ Rear Overhead Cabinets for Extra Storage.
- ✓ 18 ft. Power Awning Providing Camp Side Coverage and Multi Color LED Lighting.
- ✓ All-In-One Monitor Control Panel.

[Back To Table of Contents. Click Here](#)



Dry Weight	Hitch Weight	GVWR	Length	Width	Height	Fresh Tank	Grey Tank	Black Tank
4,822 lbs.	515 lbs.	6,400 lbs.	30' 1"	96"	10' 7"	44 gal.	40 gal.	30 gal.



Key Floorplan Features:

- ✓ Under 5,000 lb. Dry Weight; Tow Friendly.
- ✓ Double Over Double Bunks with Top Bunk Window; Partial Wall Opening up Top Bunk.
- ✓ Extra Large Jiffy Sofa with Storage Compartment Underneath.
- ✓ Extended Overhead Kitchen Cabinetry for Added Storage.
- ✓ Massive Exterior Storage Under Bunks Standard.
- ✓ Additional Overhead Dinette Cabinets.
- ✓ Spacious Bathroom with Walk in Shower and Sink.
- ✓ Partial Master Bedroom Wall Adding Privacy.
- ✓ 15 ft. Power Awning Providing Camp Side Coverage and Multi Color LED Lighting.
- ✓ All-In-One Monitor Control Panel.

[Back To Table of Contents. Click Here](#)



261BHS

Floorplan Guide



Dry Weight	Hitch Weight	GVWR	Length	Width	Height	Fresh Tank	Grey Tank	Black Tank
5,541 lbs.	646 lbs.	7,100 lbs.	30' 5"	96"	11' 1"	44 gal.	40 gal.	30 gal.

Key Floorplan Features:

- ✓ Lightweight; Tow Friendly.
- ✓ 6 ft. 9 in. Interior Height.
- ✓ Double Over Double Bunks with Rear Wall Window.
- ✓ Floor To Ceiling Pantry/Storage Closet.
- ✓ Extra Large Outside Storage Under Bunk.
- ✓ Spacious Bathroom with Walk-In Shower.
- ✓ Rack and Pinion Slide with Dinette Booth and Sofa.
- ✓ Dual Entry to the Master Bedroom.
- ✓ Complete Pass-Through Exterior Storage Compartment.
- ✓ 15 ft. Power Awning Providing Camp Side Coverage and Multi Color LED Lighting.
- ✓ All-In-One Monitor Control Panel.

[Back To Table of Contents. Click Here](#)



Dry Weight	Hitch Weight	GVWR	Length	Width	Height	Fresh Tank	Grey Tank	Black Tank
6,299 lbs.	862 lbs.	9,962 lbs.	33' 5"	96"	11' 1"	44 gal.	40 gal.	30 gal.

Key Floorplan Features:

- ✓ Rear Outside Camp Kitchen with Mini Refer, Griddle & Storage.
- ✓ Extra Large Pantry. (**ONLY VERSION OF THIS FLOORPLAN TO HAVE SUCH**)
- ✓ Double Over Double Bunks with Rear Wall Window.
- ✓ Dual Entry Trailer with Direct Entrance to Master Bedroom.
- ✓ Corner Kitchen Extending Countertop and Cabinet Storage.
- ✓ Additional Exterior Storage Under Bunks; Access on ODS.
- ✓ Rack and Pinion Super Slide With Large U-Shaped Dinette.
- ✓ Massive 21" Awning Covering Both Entry Doors with Multi-Colored LED Lighting
- ✓ Large Bathroom with Linen Closet.
- ✓ Direct View Entertainment from All Seating Areas.
- ✓ All-In-One Monitor Control Panel.